



**2018 Capitol BEST Robotics
KICKOFF**

Saturday, September 8, 2018

**Hosted by
Hutto High School**

Directions to Hutto High School:

Hutto High School

101 F.M. 685, Hutto, TX, 78636

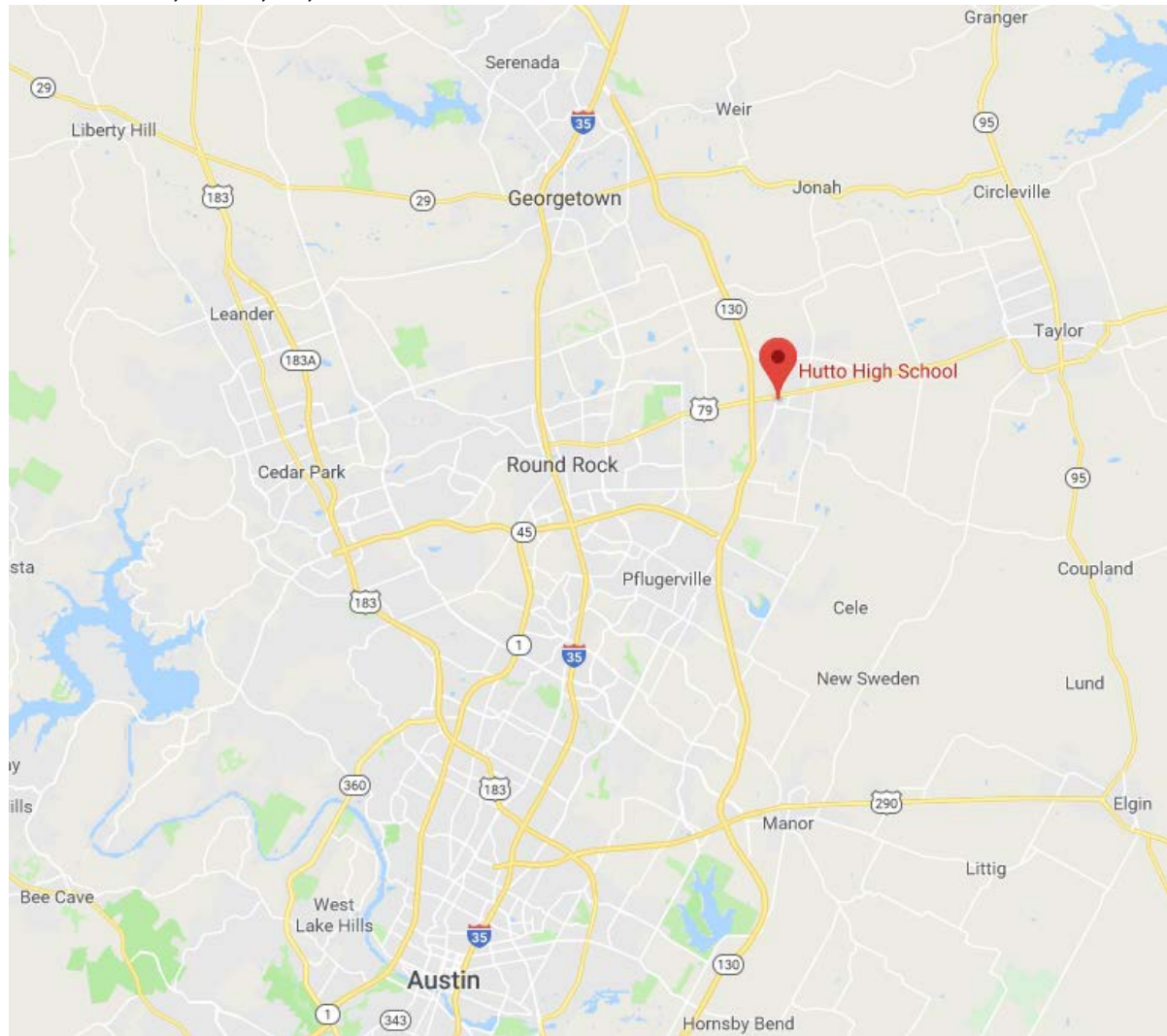

From North:

Take IH35 South to TX-130 South (Toll).
South on TX-130, exit 423, to US-79 East.
~1.0 miles, Turn right on Chris Kelley Blvd.
Turn left into Hutto HS.

From West:

US-79 East, ~9.0 miles to Hutto.
Turn right on Chris Kelley Blvd.
Turn left into Hutto HS.

From South:

Take IH35 North to US-79 East.
East on US-79, ~9.0 miles to Hutto.
Turn right on Chris Kelley Blvd.
Turn left into Hutto HS.

From South of Austin:

Take IH35 North to TX-45/TX-130 North.
North on TX-130, ~xx miles, exit 423, US-79 East
~1.0 miles, Turn right on Chris Kelley Blvd.
Turn left into Hutto HS.

Parking & Entrance

You may park in the lots near the main entrance.

Busses can park in the rear.

Enter the building only through the Main Entrance or through the courtyard (if coming from bus parking).

Arrival

Everyone is welcome to attend (students, teachers, mentors, parents, siblings, friends).

Plan to arrive early (8:30am-9:00am) and make your way to the cafeteria (straight through the front entrance). We expect over 300+ attendees. Please be on-time. We will start promptly at 9:15am.

Please do not wander through the building. Stay in the designated areas. Please be respectful of the property. It is a very nice facility and we want to leave it that way!



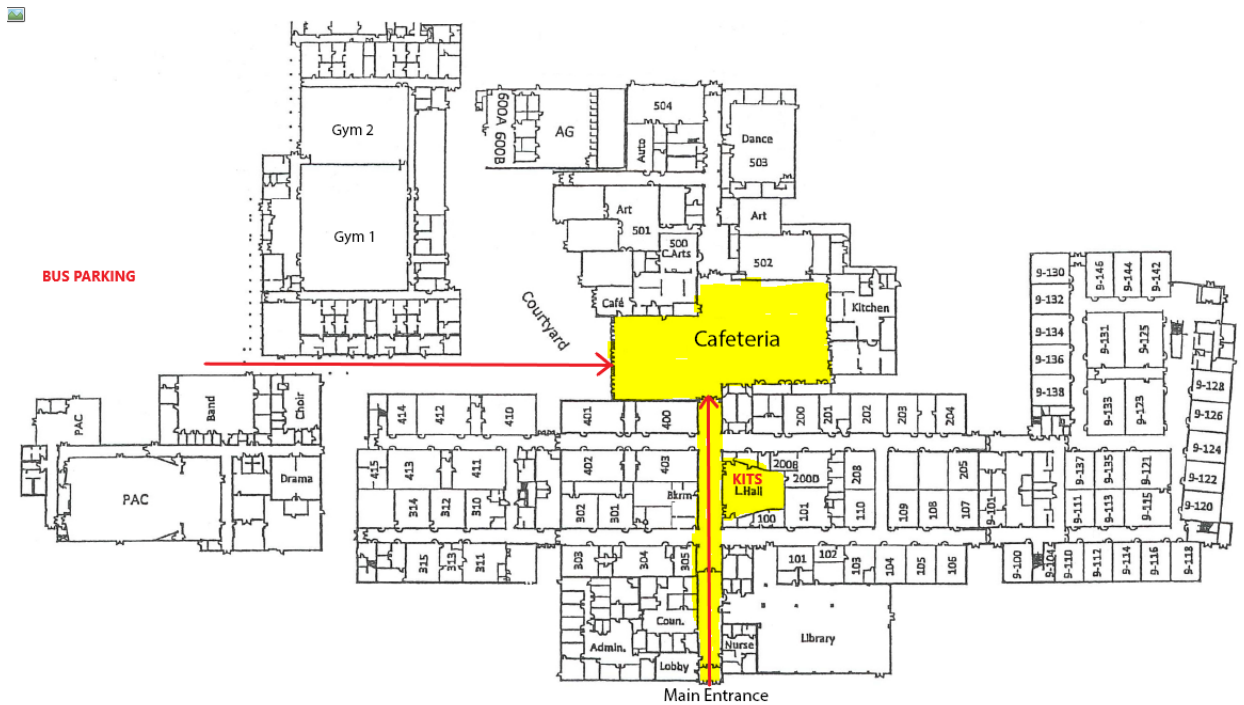

Agenda for the Day

We plan to begin presentation promptly at 9:15am in the cafeteria/commons. PLEASE BE ON-TIME.

Upon entering the building, follow the main hallway straight to the cafeteria/commons.

Time	Activity	Location
8:15am	Team Check-in & Collect team packets (teacher/team sponsor)	Main Lobby
- 9:00am	Breakfast items will be available until 9:15am	Cafeteria
9:15am	Capitol BEST Welcome & Introduction Greg Young, Director Capitol BEST, Inc.	Cafeteria
10:00am	2018 Training	Cafeteria
11:00am	2018 Current Events Game Animation/Video, Game Intro	Cafeteria
11:30am – 1:30pm	2018 Current Events Game Field Overview Explanation of game Game demonstration Q&A	Cafeteria
12:30pm	Kit Distribution Begins Return Kits (teacher must sign check-out form) Consumable Kits (use tickets provided in team packet) Inventory your kits BEFORE YOU LEAVE!	Lecture Hall

Note: all times are approximate.

Training

We will cover some useful topics for new and veteran teams. All training will be done in one session. There will be no separate break-out sessions.

Game Field Overview

The game field overview will be held around 11:30am. Complete rules will be distributed on CD. We've allocated plenty of time for Q&A.

Kit Distribution

We will distribute kits from the Lecture Hall starting about 12:30pm. We will call your team by name. Please do not enter the Lecture Hall until instructed to do so.

It's not a bad idea to get familiar with Kit parts now so you'll recognize the items when doing your inventory. The 2018 Kit Lists and additional reference material have been attached and can also be found on the BEST File Manager at:

[MAIN](#) / [2018 Game Files](#) / [Kit](#)

It is crucially important that you collect your kit materials and inventory them all on-site BEFORE YOU LEAVE. It is much more difficult to fix any discrepancies in kits after you leave. Kit Checklists will be provided.

Other Important Instructions

Bring a large enough vehicle or vehicles to take your kit parts with you. The largest pieces are 2'x4' plywood (3 pieces) and 5' long PVC bundle (~8" diameter).

SEE YOU AT KICKOFF!